

## Target 7E

Remote Viewer:	Daz Smith
Method:	CRV
Protocol:	<b>Blind</b>
Date:	15 July 2013

### The target comprises of:

structure/s  
life  
land

### The Structures are

there are more than one,  
they feel seperated and intelligently spaced/arranged within a location.

### A structure of focus was:

hard, tall, solid, rough, dens, solid.  
it felt layered with many differing and separated spaces.

The whole feel of the target felt old/past.

### The layers:

felt like a mish-mash of connected and overlapping horizontals with vertical connectors. this all felt very linear and close fitting.

Part of the structure felt lower/placed below ground - sunken. A part of the structure also felt large with sub divided spaces which was complex when viewed from above - maze-like.

A part of the target location/structures felt quiet as if used for contemplation/peace.

Temple- like.

**The life:**

there were two forms of life - one felt indigenous. these were affected by a visiting life in widespread a societal change. The indigenous felt like a past master/slave type of society - one aspect subservient to another.

The 'visiting' life, travelled to this location in vehicles/ships. they imparted new ideas, medical, science and religion and major changes to the lives of the indigenous.

Its strange - I kept seeing the indigenous life melt away from the target over a period of time. As if changed - big society changes and they just over time dissolved and moved away.

I saw new life/travellers - bring new ideas and large changes in a short period of time. This new group of life feel and act dominant/superior - more knowledgeable and they share this.

Over a decade or two the indigenous life just depart and move on/fade away.

**The travellers:**

taller, softly spoken, soft mannerisms, peaceful - not war-like.  
whiter in skin tone.

they are explorers.  
Share knowledge and ideas.

enlightened.

bring about an age of renaissance/ a golden age.

A large societal change is happening here.

**Others details:**

Sound - very low frequency more of a hum or vibration than a noise.

A low vibration everywhere at this target.

Page: 1  
TARGET: FE.

Stage: 1

D.  
1.45pm  
CRU.  
Blind  
15.7.13.

P.T: FINE. 20 MIN COOLEDOWN / MEDICATION.



A: DOWN, ACROSS, DOWN, DOWN, ACROSS.

SOLID

B: Lamin

S2

IRREGULAR.

RUGGED

DRY.

YELLOW

DUSKY

BACKED

SOLID

HEAVY

ANYPET.

DENSE.

HARD

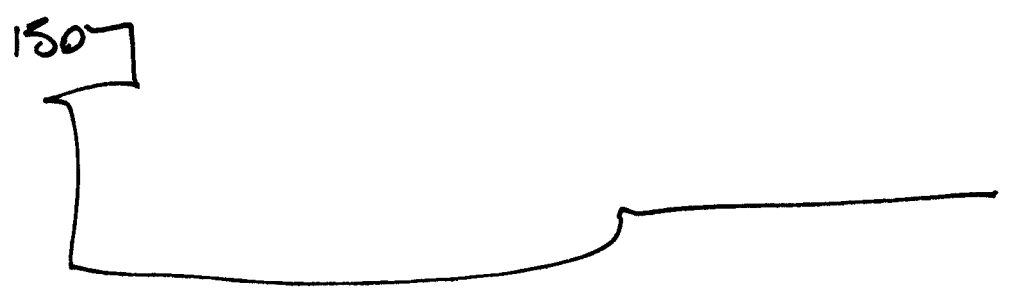

A: Across. rising, Across.  
Hard.

B: ~~Structure~~

SZ

Dense.

Flattened.

Angular

Solid

Thick.

Sectioned

Spaced.

Linear

Composed

Standard

Dry

Old.

AL  
PAST.



A: up, across, across, repeated  
 HALLS

B: STRUCTURE:

$\frac{52}{}$   
 SAID

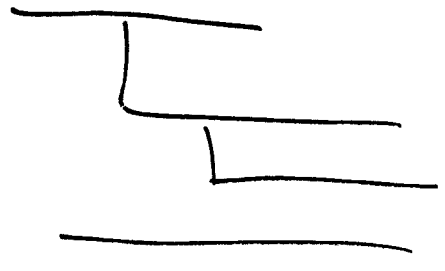

LAYERS.

MISH - WASH.

MIXED

SHAPES.

LINEAR

FITTED

FITTING

TOTAL

CLOSE.

AOL  
 WALLS.

1507



Angular  
 Sharp  
 Rising  
 Sharp.

Sand  
 oil  
 part.

Sectional.

Horizontal.

Layered.

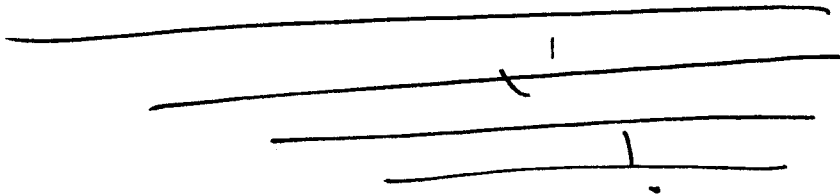

1/2 feet folded. mixed horizontal/vertical  
 components.

A: WIND.

T1: HARD, DRY. SOID, WARM.

T2: HOT.

✓

COLOURS: YELLOW, ORANGE. GREY, RED.

LUM: BRIGHT.

CON: HIGH.

T3: DUSTY. ~~EARTH~~

O: OZONE.

ES: VIBRATION.

SOUND.

LOW - ALMOST HIDDEN.

ALL  
LOW FREQ  
SOUND.

SUB: LIFE: / HARBE CALINE

D.

H: == FLAT LANGUAGED

V: PACKED / DENSE.

D —

MOSU: HEAVY, SPACED, NEARLY SOID

ANNULAL.

DE: AN INTERESTING DEAL.

1507

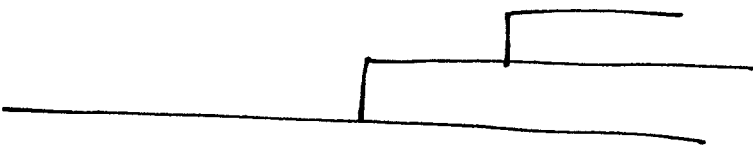
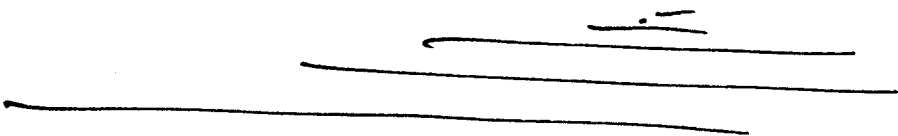
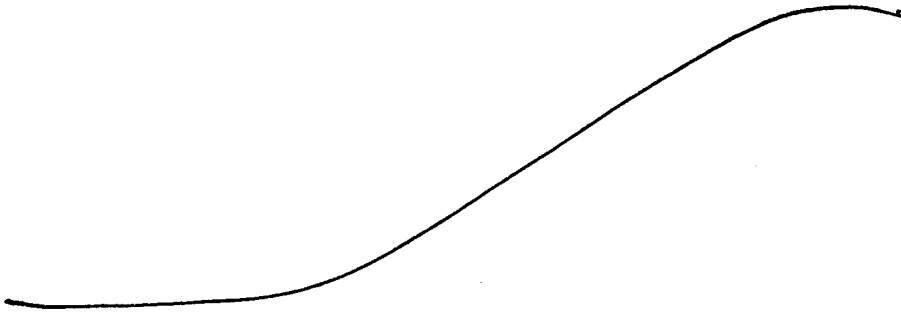



1507

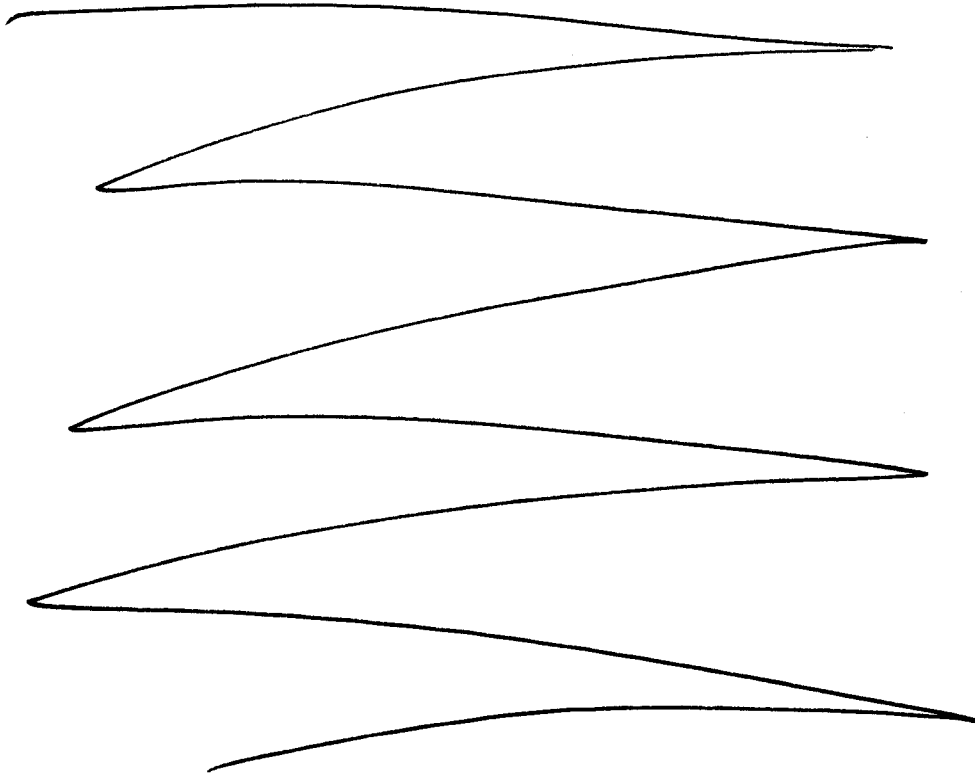

Raised.

Built.

Separated

spaces.

S3 1/2: this feels like a built-up page.  
Layered construction.

old

part.

AdL  
CELEBRATION

708

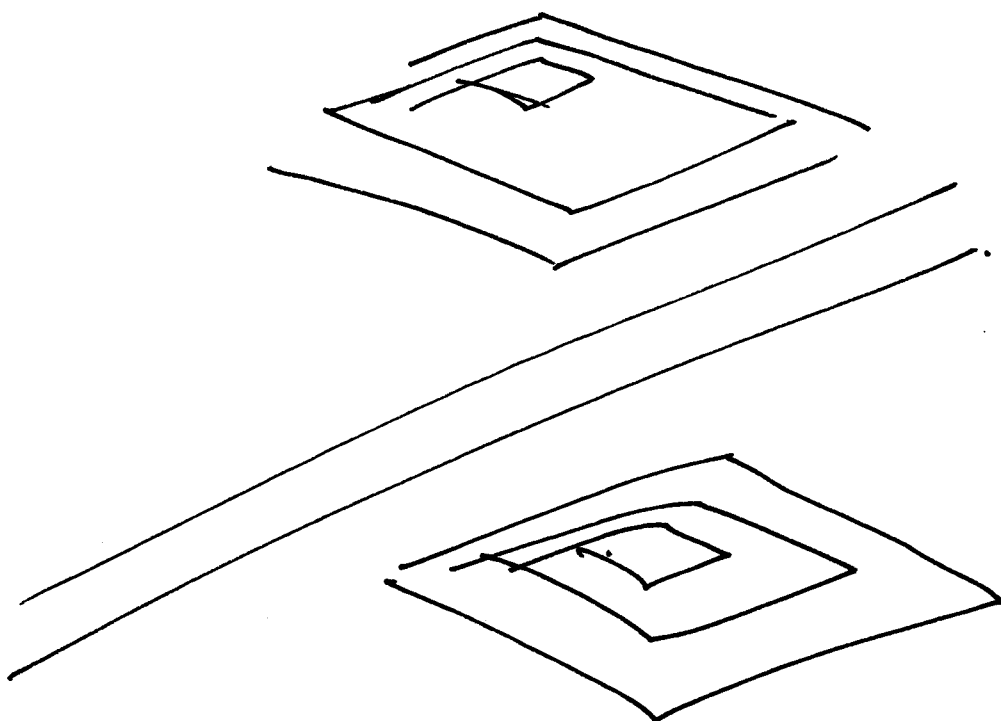

MORE THAN ONE STRUCTURE.

ARRANGED - SITUATED IN A WIDE LANDSCAPE.

DRY, OPEN, OLD, REMOTE.

PAST.

S2 D AC EC T I DPL DPL

TAN  
DENSE  
Solid  
Annullum.

STRUCTURE.

S4 1/2: complex layout. TAN, COOL INSIDE. DENSE.

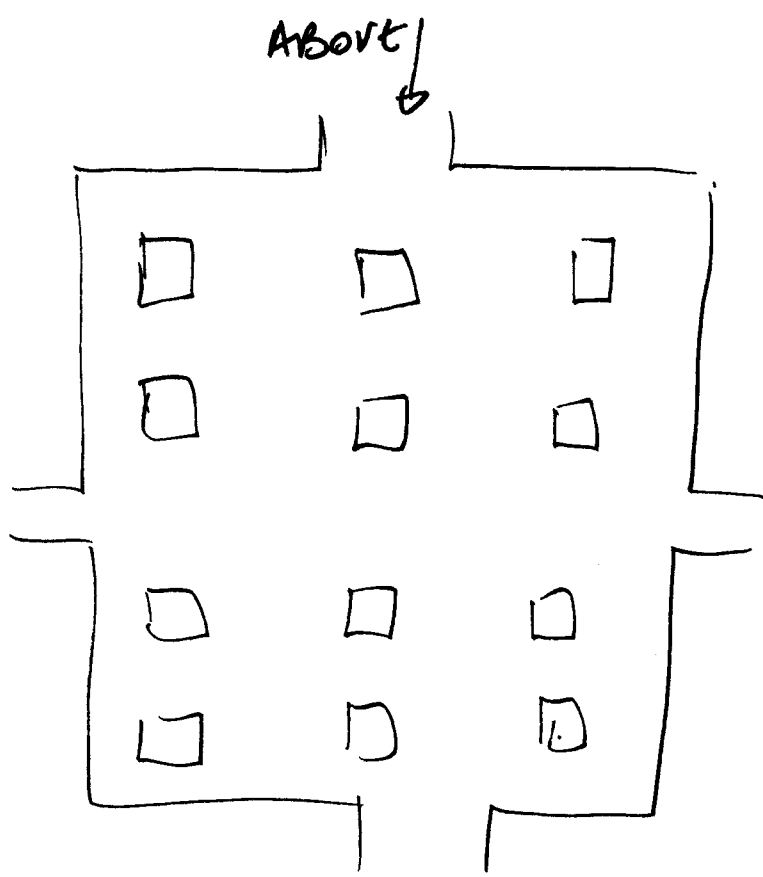

ARRANGED SPACES.  
MAZE-LIKE.  
ARRANGEMENTS.

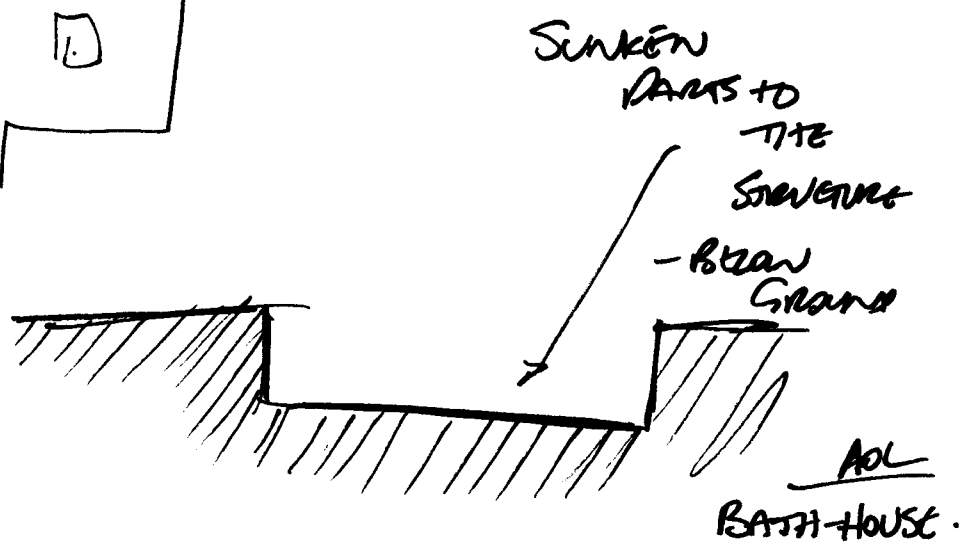

SZ

D

AC

EC

T

F

WOL

WOL

LIFE

POST-

WORKING.

SL#2: THIS FEELS LIKE A SLAVE-MASTER TYPE SOCIETY - WITH  
LOT OF PEOPLE STRUNG/WAITING-UPON OTHERS -  
LOTS OF CARRYING.

SILENCE - A FEEL OF QUIETNESS - MEDITATION  
AREAS SET ASIDE FOR CONTEMPLATION/COMMUNION.

THIS FEELS LIKE AN ANCIENT CITY WITH TEMPLES.

AN AREA OF EVERYDAY LIFE - THAT GOES THROUGH A CHANGE.

THE LIFE - JUST KIND OF FALL AWAY - MOVE AWAY.  
LEAVING JUST THOSE IMPRESSIVE STRUCTURES.

WHY?

ITS LIKE SOMETHING DISAPPEARS - THEIR IDEAS/FAITH/RELIGION OR  
SOMETHING? A LARGE BELIEF/SOCIETY COMPONENTS CHANGES -  
THE PEOPLE JUST LEAVE - LITTLE BY LITTLE UNTIL ITS VACANT.

S2      D      AC      EC      T      =      AC      days

---

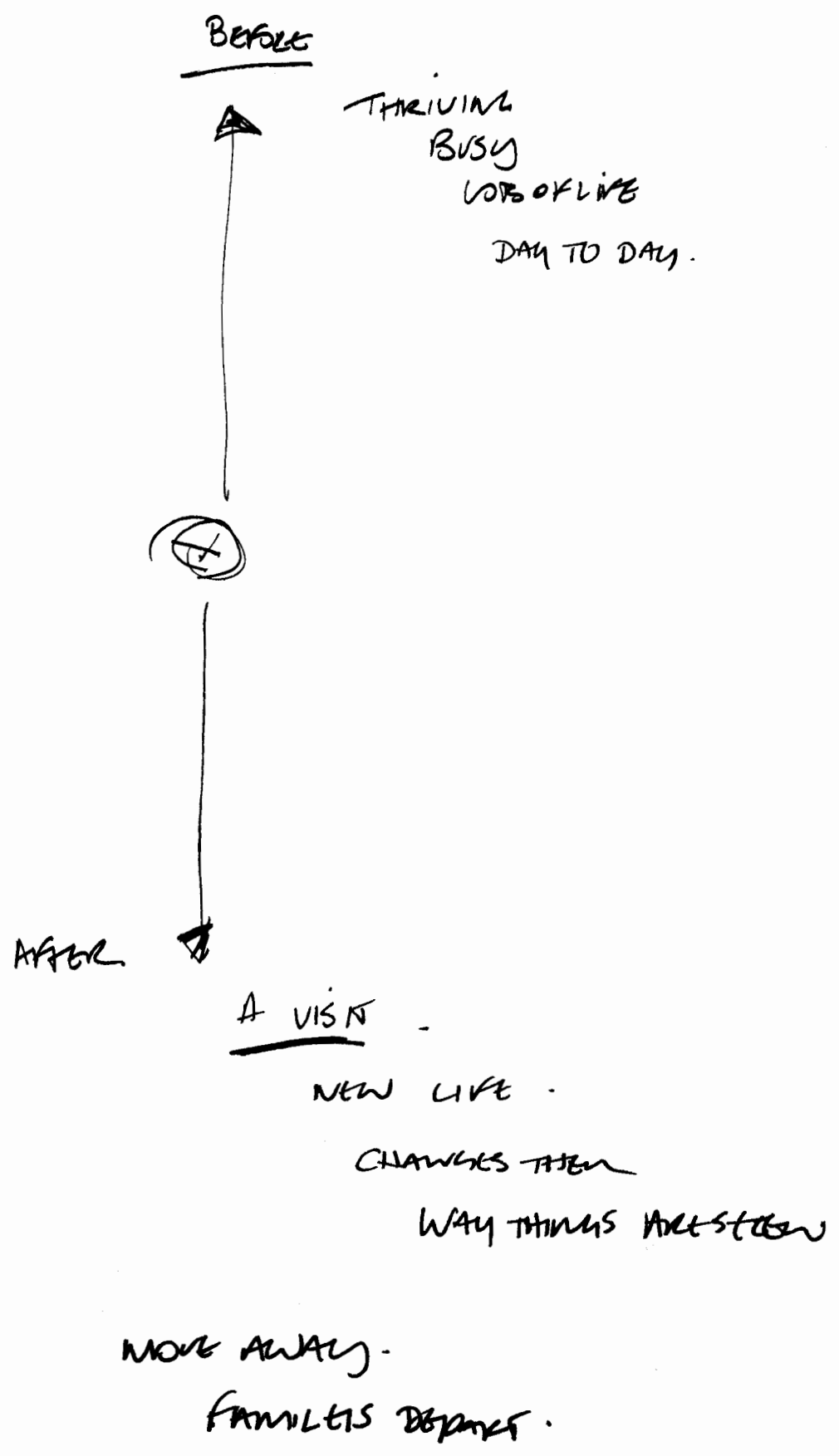

S2 D AS EC T F Ap Ap/r.

DESCRIBING - THE CHANGE.

LIFE

TRAVELLERS .

IN  
STEPS

FROM AHEAD.

NEW IDEAS  
TECHNOLOGY

ANSWERS.

SCIENCE  
MEDICAL.  
KNOWLEDGE.

S42: A feel of a LARGE SCIENTIFIC CHANGE OVER A  
SHORT PERIOD OF TIME - BRINGING ON BY A  
VISIT FROM A SUPERIOR / ADVANCED LIFE.

ENLIGHTENED.

SLOWLY OVER 4 DECADES OR SO. PEOPLE DISGUISED.

SZ D AC EC T F Val Naps

---

NEW LIFE

SOFT  
QUIET

NOT  
WAR-LIKE.

IDEAS-  
KNOWLEDGE

SHARING

TRAVEL

WINTER.

S42: THEY FEEL PEACEFUL - AT ONE WITH THINGS.

TRAVELING A LONG DISTANCE IN VEHICLES -  
EXPLORES.

SHARING KNOWLEDGE IDEAS.

SCIENCE.  
MEDICAL.

AND EDUCATION  
ENLIGHTENMENT.

RENACISSANCE

GOLDEN/NEW AGE.

THIS FEELS LIKE A LARGE WINTER SOLISTAR CHANGE-EVENT.

2.55pm

END 😊 DAL